

SANITARY ZERO STATIC TEE ANGLE BLEED VALVES – TOGGLE SAFETY HANDLE

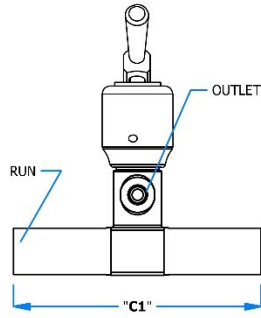

INLET – AUTOWELD RUN;
OUTLET – HOSE BARB;

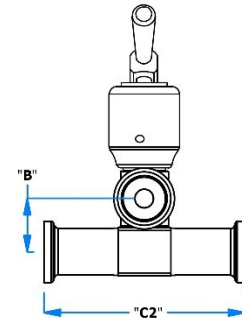
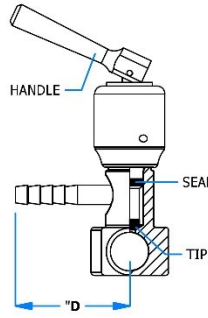

INLET – TC RUN;
OUTLET – TC;

SANITARY ZERO STATIC TEE ANGLE BLEED VALVES – TOGGLE SAFETY HANDLE (Ø 0.187" INLET BORE SIZE)					
1/4" HB OUTLET	A/W RUN	PART #	"B" DIM	"C1" DIM	"D" DIM
	0.5"	SRGBN2A*	0.79"	3.85"	1.85"
	0.75"	SRGFN2A	0.91"	4.00"	1.85"
	1.0"	SRGLN2A	1.04"	4.10"	1.85"
	1.5"	SRGSN2A	1.29"	5.30"	1.85"
	2.0"	SRGZN2A	1.55"	7.00"	1.85"
	2.5"	SRHJN2A	1.79"	7.00"	1.85"
	3.0"	SRJDN2A	2.05"	9.00"	1.85"
4.0"	SRJTN2A	2.53"	11.00"	1.85"	
1/4" HB OUTLET	TC RUN	PART #	"B" DIM	"C2" DIM	"D" DIM
	0.5"	SRGBR2A	0.79"	3.10"	1.85"
	0.75"	SRGFR2A	0.91"	3.25"	1.85"
	1.0"	SRGLR2A	1.04"	3.35"	1.85"
	1.5"	SRGSR2A	1.29"	3.25"	1.85"
	2.0"	SRGZR2A	1.55"	3.25"	1.85"
	2.5"	SRHJR2A	1.79"	3.25"	1.85"
	3.0"	SRJDR2A	2.05"	3.25"	1.85"
4.0"	SRJTR2A	2.53"	3.25"	1.85"	
3/8" TC OUTLET	A/W RUN	PART #	"B" DIM	"C1" DIM	"D" DIM
	0.5"	SRGCQ2A	0.73"	3.85"	2.75"
	0.75"	SRGGQ2A	0.86"	4.00"	2.75"
	1.0"	SRGMQ2A	0.98"	4.10"	2.75"
	1.5"	SRGTQ2A	1.23"	5.30"	2.75"
	2.0"	SRHAQ2A	1.50"	7.00"	2.75"
	2.5"	SRHKQ2A	1.74"	7.00"	2.75"
	3.0"	SRJEQ2A	2.00"	9.00"	2.75"
4.0"	SRJUQ2A	2.48"	11.00"	2.75"	
3/8" TC OUTLET	TC RUN	PART #	"B" DIM	"C2" DIM	"D" DIM
	0.5"	SRGCT2A	0.73"	3.10"	2.75"
	0.75"	SRGGT2A	0.86"	3.25"	2.75"
	1.0"	SRGMT2A	0.98"	3.35"	2.75"
	1.5"	SRGTT2A	1.23"	3.25"	2.75"
	2.0"	SRHAT2A	1.50"	3.25"	2.75"
	2.5"	SRHKT2A	1.74"	3.25"	2.75"
	3.0"	SRJET2A	2.00"	3.25"	2.75"
4.0"	SRJUT2A	2.48"	3.25"	2.75"	

SANITARY ZERO STATIC TEE ANGLE BLEED VALVES – TOGGLE SAFETY HANDLE CONFIGURATION

EXAMPLE: PART# **SRGBN2A*** – 1/4" HB **OUTLET** X 0.5" AUTOWELDED RUN **INLET** ZERO STATIC TEE ANGLE BLEED VALVE

S R G B N 2 A _ _ _ _ _

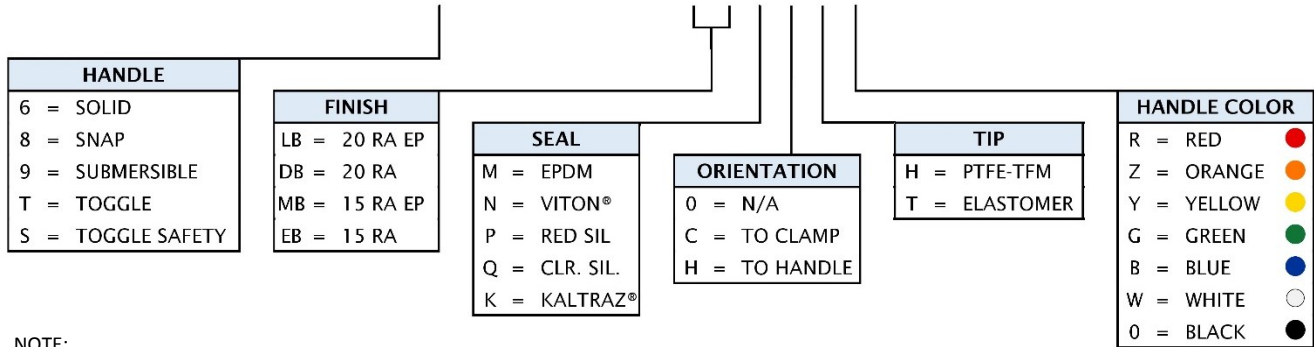

NOTE:

Custom end connections available on request. Please contact a sales representative.

VITON® is a registered trademark of DuPont Performance Elastomers.
KALTRAZ® is a registered trademark of Advant O Seal.

SANITARY ZERO STATIC TEE ANGLE BLEED VALVES – TOGGLE SAFETY HANDLE – SPARES

BLEED VALVE SPARE SEALS FOR STEM CAN BE ORDERED IN TWO PACKAGING TYPES DEPENDING ON INVENTORY REQUIREMENTS TO SUIT CUSTOMER NEEDS.

SEALS FOR STEM					
SEAL MATERIAL			PART #		
			SET		KIT
TEFLON® TIP	TEFLON® TIP	— EPDM O-RING	SR0003M	— SET	SR0003M — KIT
	TEFLON® TIP	— VITON® O-RING	SR0003N	— SET	SR0003N — KIT
	TEFLON® TIP	— RED SIL. O-RING	SR0003P	— SET	SR0003P — KIT
	TEFLON® TIP	— CLR. SIL. O-RING	SR0003Q	— SET	SR0003Q — KIT
	TEFLON® TIP	— KALTRAZ® O-RING	SR0003K	— SET	SR0003K — KIT
ELASTOMER TIP	EPDM TIP	— EPDM O-RING	SR000ZM	— SET	SR000ZM — KIT
	VITON® TIP	— VITON® O-RING	SR000ZN	— SET	SR000ZN — KIT
	RED SIL. TIP	— RED SIL. O-RING	SR000ZP	— SET	SR000ZP — KIT
	CLR SIL. TIP	— CLR. SIL. O-RING	SR000ZQ	— SET	SR000ZQ — KIT
	KALTRAZ® TIP	— KALTRAZ® O-RING	SR000ZK	— SET	SR000ZK — KIT

NOTES:

- 1 SET CONTAINS = (1) TIP, (1) O-RING, (1) DOWEL PIN
- 1 KIT CONTAINS = (5) TIPS, (5) O-RINGS, (5) DOWEL PINS

LOCK SCREWS	
PART#	6B000HA

NOTES:

- 1 UNIT = (3) LOCK SCREWS + (1) ALLEN WRENCH

O-RING LUBE	
PART#	6Z0009

NOTES:

- PLEASE REFER TO FLT O-RING LUBE DATA SHEET FOR SPECIFICATION