

SANITARY ANGLE SAMPLE VALVES – SUBMERSIBLE HANDLE

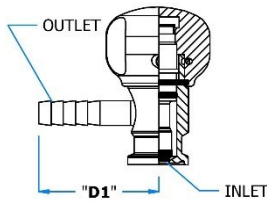

INLET - FRAC. TC;
OUTLET - HOSE BARB;

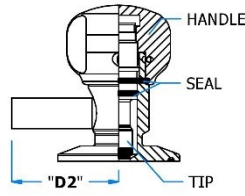

INLET - CONC. TC;
OUTLET - TUBE;

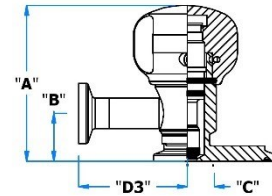

INLET - ECC. TC;
OUTLET - TC;

SANITARY ANGLE SAMPLE VALVES – SUBMERSIBLE HANDLE (Ø 0.370" INLET BORE SIZE)						
3/8" HB OUTLET	INLET	PART #	"A" DIM	"B" DIM	"C" DIM	"D1" DIM
	0.5" & 0.75"	9CGGA2A*	2.55"	0.86"		1.94"
	1.0" CONC.	9CGMA2A	2.55"	0.83"		1.94"
	1.0" ECC.	9CGMD2A	2.55"	0.83"	0.222"	1.94"
	1.5" CONC.	9CGTA2A	2.55"	0.83"		1.94"
	1.5" ECC.	9CGTD2A	2.55"	0.83"	0.472"	1.94"
	2.0" CONC.	9CHAA2A	2.55"	0.83"		2.25"
	2.0" ECC.	9CHAD2A	2.55"	0.83"	0.722"	1.94"
	2.5" CONC.	9CHKA2A	2.55"	0.83"		2.50"
	2.5" ECC.	9CHKD2A	2.55"	0.83"	0.970"	1.94"
	3.0" CONC.	9CJEA2A	2.55"	0.83"		2.75"
	3.0" ECC.	9CJED2A	2.55"	0.83"	1.222"	1.94"
4.0" CONC.	9CJUA2A	2.55"	0.83"		3.25"	
4.0" ECC.	9CJUD2A	2.55"	0.83"	1.704"	1.94"	
3/8" TUBE OUTLET	INLET	PART #	"A" DIM	"B" DIM	"C" DIM	"D2" DIM
	0.5" & 0.75"	9CGGB2A	2.55"	0.86"		2.00"
	1.0" CONC.	9CGMB2A	2.55"	0.84"		2.25"
	1.0" ECC.	9CGME2A	2.55"	0.84"	0.222"	2.03"
	1.5" CONC.	9CGTB2A	2.55"	0.84"		2.25"
	1.5" ECC.	9CGTE2A	2.55"	0.84"	0.472"	2.03"
	2.0" CONC.	9CHAB2A	2.55"	0.84"		2.75"
	2.0" ECC.	9CHAE2A	2.55"	0.84"	0.722"	2.03"
	2.5" CONC.	9CHKB2A	2.55"	0.84"		3.00"
	2.5" ECC.	9CHKE2A	2.55"	0.84"	0.970"	2.03"
	3.0" CONC.	9CJEB2A	2.55"	0.84"		3.25"
	3.0" ECC.	9CJEE2A	2.55"	0.84"	1.222"	2.03"
4.0" CONC.	9CJUB2A	2.55"	0.84"		3.75"	
4.0" ECC.	9CJUE2A	2.55"	0.84"	1.704"	2.03"	
1/2" TC OUTLET	INLET	PART #	"A" DIM	"B" DIM	"C" DIM	"D3" DIM
	0.5" & 0.75"	9CGHC2A	2.55"	0.83"		2.00"
	1.0" CONC.	9CGNC2A	2.55"	0.80"		2.25"
	1.0" ECC.	9CGNF2A	2.55"	0.80"	0.222"	2.03"
	1.5" CONC.	9CGUC2A	2.55"	0.80"		2.25"
	1.5" ECC.	9CGUF2A	2.55"	0.80"	0.472"	2.03"
	2.0" CONC.	9CHBC2A	2.55"	0.80"		2.75"
	2.0" ECC.	9CHBF2A	2.55"	0.80"	0.722"	2.03"
	2.5" CONC.	9CHLC2A	2.55"	0.80"		3.00"
	2.5" ECC.	9CHLF2A	2.55"	0.80"	0.970"	2.03"
	3.0" CONC.	9CJFC2A	2.55"	0.80"		3.25"
	3.0" ECC.	9CJFF2A	2.55"	0.80"	1.222"	2.03"
4.0" CONC.	9CJVC2A	2.55"	0.80"		3.75"	
4.0" ECC.	9CJV2A	2.55"	0.80"	1.704"	2.03"	

SANITARY ANGLE SAMPLE VALVES – SUBMERSIBLE HANDLE

SANITARY ANGLE SAMPLE VALVES – SUBMERSIBLE HANDLE (Ø 0.370" INLET BORE SIZE)						
	INLET	PART #	"A" DIM	"B" DIM	"C" DIM	"D1" DIM
1/2" HB OUTLET	0.5" & 0.75"	9CGHA2A	2.55"	0.83"		1.94"
	1.0" CONC.	9CGNA2A	2.55"	0.81"		1.94"
	1.0" ECC.	9CGND2A	2.55"	0.81"	0.222"	1.94"
	1.5" CONC.	9CGUA2A	2.55"	0.81"		1.94"
	1.5" ECC.	9CGUD2A	2.55"	0.81"	0.472"	1.94"
	2.0" CONC.	9CHBA2A	2.55"	0.81"		2.25"
	2.0" ECC.	9CHBD2A	2.55"	0.81"	0.722"	1.94"
	2.5" CONC.	9CHLA2A	2.55"	0.81"		2.50"
	2.5" ECC.	9CHLD2A	2.55"	0.81"	0.970"	1.94"
	3.0" CONC.	9CJFA2A	2.55"	0.81"		2.75"
	3.0" ECC.	9CJFD2A	2.55"	0.81"	1.222"	1.94"
	4.0" CONC.	9CJVA2A	2.55"	0.81"		3.25"
4.0" ECC.	9CJVD2A	2.55"	0.81"	1.704"	1.94"	

	INLET	PART #	"A" DIM	"B" DIM	"C" DIM	"D2" DIM
1/2" TUBE OUTLET	0.5" & 0.75"	9CGHB2A	2.55"	0.83"		2.00"
	1.0" CONC.	9CGNB2A	2.55"	0.80"		2.25"
	1.0" ECC.	9CGNE2A	2.55"	0.80"	0.222"	2.03"
	1.5" CONC.	9CGUB2A	2.55"	0.80"		2.25"
	1.5" ECC.	9CGUE2A	2.55"	0.80"	0.472"	2.03"
	2.0" CONC.	9CHBB2A	2.55"	0.80"		2.75"
	2.0" ECC.	9CHBE2A	2.55"	0.80"	0.722"	2.03"
	2.5" CONC.	9CHLB2A	2.55"	0.80"		3.00"
	2.5" ECC.	9CHLE2A	2.55"	0.80"	0.970"	2.03"
	3.0" CONC.	9CJFB2A	2.55"	0.80"		3.25"
	3.0" ECC.	9CJFE2A	2.55"	0.80"	1.222"	2.03"
	4.0" CONC.	9CJVB2A	2.55"	0.80"		3.75"
4.0" ECC.	9CJVE2A	2.55"	0.80"	1.704"	2.03"	

SANITARY ANGLE SAMPLE VALVES – SUBMERSIBLE HANDLE CONFIGURATION

EXAMPLE: PART# **9CGGA2A*** – 3/8" HB OUTLET X 0.5" TC INLET ANGLE SAMPLE VALVE

9CGGA2A _ _ _ _ _

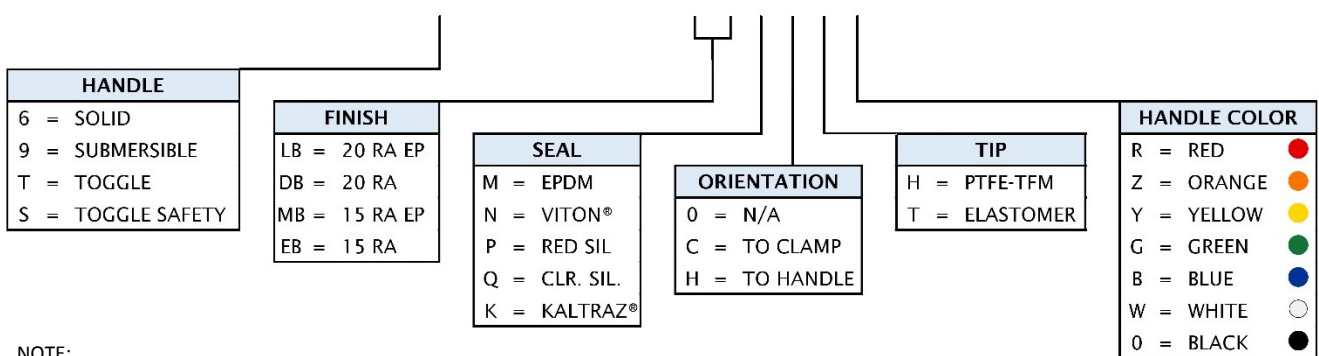

NOTE:

Custom end connections available on request. Please contact a sales representative.

VITON® is a registered trademark of DuPont Performance Elastomers.
KALTRAZ® is a registered trademark of Advant O Seal.

SANITARY ANGLE SAMPLE VALVES – SUBMERSIBLE HANDLE – SPARES

SAMPLE VALVE SPARE SEALS FOR STEM CAN BE ORDERED IN TWO PACKAGING TYPES DEPENDING ON INVENTORY REQUIREMENTS TO SUIT CUSTOMER NEEDS.

SEALS FOR STEM					
SEAL MATERIAL			PART #		
			SET		KIT
TEFLON® TIP	TEFLON® TIP	— EPDM O-RING	9C0003M	— SET	9C0003M — KIT
	TEFLON® TIP	— VITON® O-RING	9C0003N	— SET	9C0003N — KIT
	TEFLON® TIP	— RED SIL. O-RING	9C0003P	— SET	9C0003P — KIT
	TEFLON® TIP	— CLR. SIL. O-RING	9C0003Q	— SET	9C0003Q — KIT
	TEFLON® TIP	— KALTRAZ® O-RING	9C0003K	— SET	9C0003K — KIT
ELASTOMER TIP	EPDM TIP	— EPDM O-RING	9C000ZM	— SET	9C000ZM — KIT
	VITON® TIP	— VITON® O-RING	9C000ZN	— SET	9C000ZN — KIT
	RED SIL. TIP	— RED SIL. O-RING	9C000ZP	— SET	9C000ZP — KIT
	CLR SIL. TIP	— CLR. SIL. O-RING	9C000ZQ	— SET	9C000ZQ — KIT
	KALTRAZ® TIP	— KALTRAZ® O-RING	9C000ZK	— SET	9C000ZK — KIT

NOTES:

- 1 SET CONTAINS = (1) TIP, (1) STEM O-RING, (1) DOWEL PIN
- 1 KIT CONTAINS = (5) TIPS, (5) STEM O-RINGS, (5) DOWEL PINS

STEM			
TIP	FINISH		
	20 RA		15 RA/EP
TEFLON® TIP	6C000BADB		6C000BAMB
ELASTOMER TIP	6C000TADB		6C000TAMB

NOTES:

- ELASTOMER IS USED AS A REFERENCE FOR MATERIALS LIKE EPDM, VITON®, RED SILICONE, CLEAR SILICONE AND KALTRAZ®

SAMPLE VALVE SPARE SEALS FOR HANDLE CAN BE ORDERED IN TWO PACKAGING TYPES DEPENDING ON INVENTORY REQUIREMENTS TO SUIT CUSTOMER NEEDS.

SEALS FOR HANDLE			
HANDLE O-RING	PART #		
	SET		KIT
EPDM	9C000QM	— SET	9C000QM — KIT
VITON®	9C000QN	— SET	9C000QN — KIT
RED SIL.	9C000QP	— SET	9C000QP — KIT
CLR SIL.	9C000QQ	— SET	9C000QQ — KIT
KALTRAZ®	9C000QK	— SET	9C000QK — KIT

NOTES:

- 1 SET CONTAINS = (3) LOCK SCREWS, (1) HANDLE O-RING, (1) ALLEN WRENCH
- 1 KIT CONTAINS = (15) LOCK SCREWS, (5) HANDLE O-RING, (1) ALLEN WRENCH

HANDLE	
HANDLE COLOR	PART #
RED	9C000DS — R
ORANGE	9C000DS — Z
YELLOW	9C000DS — Y
GREEN	9C000DS — G
BLUE	9C000DS — B
WHITE	9C000DS — W
BLACK	9C000DG — 0

LOCK SCREWS	
SCREW O-RING TYPE	PART #
EPDM	9C000HA – M
VITON®	9C000HA – N
RED SIL.	9C000HA – P
CLR SIL.	9C000HA – Q
KALTRAZ®	9C000HA – K

NOTES:

- 1 UNIT = (3) LOCK SCREWS + (1) ALLEN WRENCH

O-RING LUBE	
PART#	
	6Z0009

NOTES:

- PLEASE REFER TO FLT O-RING LUBE DATA SHEET FOR SPECIFICATION