

SANITARY ZERO STATIC TEE ANGLE SAMPLE VALVES - TOGGLE HANDLE

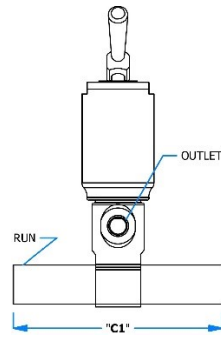

INLET - AUTOWELDED RUN;
OUTLET - HOSE BARB;

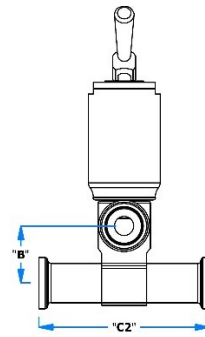
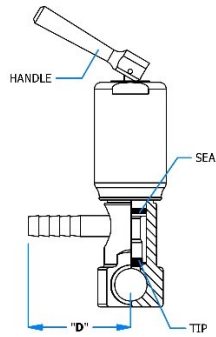

INLET - TC RUN;
OUTLET - TC;

SANITARY ZERO STATIC TEE ANGLE SAMPLE VALVES - TOGGLE HANDLE (Ø 0.370" INLET BORE SIZE)					
3/8" HB OUTLET	A/W RUN	PART #	"B" DIM	"C1" DIM	"D" DIM
	0.5"	TEGCN2A*	1.00"	3.87"	1.94"
	0.75"	TEGGR2A	1.12"	4.00"	1.94"
	1.0"	TEGMN2A	1.25"	4.00"	1.94"
	1.5"	TEGTN2A	1.51"	5.00"	1.94"
	2.0"	TEHAN2A	1.75"	7.20"	1.94"
	2.5"	TEHKN2A	2.00"	7.20"	1.94"
	3.0"	TEJEN2A	2.25"	9.20"	1.94"
4.0"	TEJUN2A	2.72"	11.20"	1.94"	
3/8" HB OUTLET	TC RUN	PART #	"B" DIM	"C2" DIM	"D" DIM
	0.5"	TEGCR2A	1.00"	3.12"	1.94"
	0.75"	TEGGR2A	1.12"	3.26"	1.94"
	1.0"	TEGMR2A	1.25"	3.25"	1.94"
	1.5"	TEGTR2A	1.51"	3.45"	1.94"
	2.0"	TEHAR2A	1.75"	3.45"	1.94"
	2.5"	TEHCR2A	2.00"	3.45"	1.94"
	3.0"	TEJER2A	2.25"	3.45"	1.94"
4.0"	TEJUR2A	2.72"	3.45"	1.94"	
1/2" HB OUTLET	A/W RUN	PART #	"B" DIM	"C1" DIM	"D" DIM
	0.5"	TEBUN2A	0.98"	3.87"	1.94"
	0.75"	TEGHN2A	1.10"	4.00"	1.94"
	1.0"	TEGNN2A	1.23"	4.00"	1.94"
	1.5"	TEGUN2A	1.49"	5.00"	1.94"
	2.0"	TEHBN2A	1.73"	7.20"	1.94"
	2.5"	TEHLN2A	1.98"	7.20"	1.94"
	3.0"	TEJFN2A	2.23"	9.20"	1.94"
4.0"	TEJVN2A	2.70"	11.20"	1.94"	
1/2" HB OUTLET	TC RUN	PART #	"B" DIM	"C2" DIM	"D" DIM
	0.5"	TEBUR2A	0.98"	3.12"	1.94"
	0.75"	TEGHR2A	1.10"	3.26"	1.94"
	1.0"	TEGHR2A	1.23"	3.25"	1.94"
	1.5"	TEGUR2A	1.49"	3.45"	1.94"
	2.0"	TEHBR2A	1.73"	3.45"	1.94"
	2.5"	TEHLR2A	1.98"	3.45"	1.94"
	3.0"	TEJFR2A	2.23"	3.45"	1.94"
4.0"	TEJVR2A	2.70"	3.45"	1.94"	

SANITARY ZERO STATIC TEE ANGLE SAMPLE VALVES – TOGGLE HANDLE

SANITARY ZERO STATIC TEE ANGLE SAMPLE VALVES – TOGGLE HANDLE (Ø 0.370" INLET BORE SIZE)					
3/8" TUBE OUTLET	A/W RUN	PART #	"B" DIM	"C1" DIM	"D" DIM
	0.5"	TEGCP2A	1.00"	3.87"	2.75"
	0.75"	TEGGP2A	1.12"	4.00"	2.75"
	1.0"	TEGMP2A	1.25"	4.00"	2.75"
	1.5"	TEGTP2A	1.51"	5.00"	2.75"
	2.0"	TEHAP2A	1.75"	7.20"	2.75"
	2.5"	TEHKP2A	2.00"	7.20"	2.75"
	3.0"	TEJEP2A	2.25"	9.20"	2.75"
4.0"	TEJUP2A	2.72"	11.20"	2.75"	
3/8" TUBE OUTLET	TC RUN	PART #	"B" DIM	"C2" DIM	"D" DIM
	0.5"	TEGCS2A	1.00"	3.12"	2.75"
	0.75"	TEGGS2A	1.12"	3.26"	2.75"
	1.0"	TEGMS2A	1.25"	3.25"	2.75"
	1.5"	TEGTS2A	1.51"	3.45"	2.75"
	2.0"	TEHAS2A	1.75"	3.45"	2.75"
	2.5"	TEHKS2A	2.00"	3.45"	2.75"
	3.0"	TEJES2A	2.25"	3.45"	2.75"
4.0"	TEJUS2A	2.72"	3.45"	2.75"	
1/2" TUBE OUTLET	A/W RUN	PART #	"B" DIM	"C1" DIM	"D" DIM
	0.5"	TEBUP2A	0.97"	3.87"	2.75"
	0.75"	TEGHP2A	1.09"	4.00"	2.75"
	1.0"	TEGNP2A	1.22"	4.00"	2.75"
	1.5"	TEGUP2A	1.48"	5.00"	2.75"
	2.0"	TEHBP2A	1.72"	7.20"	2.75"
	2.5"	TEHLP2A	1.97"	7.20"	2.75"
	3.0"	TEJFP2A	2.22"	9.20"	2.75"
4.0"	TEJVP2A	2.69"	11.20"	2.75"	
1/2" TUBE OUTLET	TC RUN	PART #	"B" DIM	"C2" DIM	"D" DIM
	0.5"	TEBUS2A	0.97"	3.12"	2.75"
	0.75"	TEGHS2A	1.09"	3.26"	2.75"
	1.0"	TEGNS2A	1.22"	3.25"	2.75"
	1.5"	TEGUS2A	1.48"	3.45"	2.75"
	2.0"	TEHBS2A	1.72"	3.45"	2.75"
	2.5"	TEHLS2A	1.97"	3.45"	2.75"
	3.0"	TEJFS2A	2.22"	3.45"	2.75"
4.0"	TEJVS2A	2.69"	3.45"	2.75"	
1/2" TC OUTLET	A/W RUN	PART #	"B" DIM	"C1" DIM	"D" DIM
	0.5"	TEBUQ2A	0.97"	3.87"	2.75"
	0.75"	TEGHQ2A	1.09"	4.00"	2.75"
	1.0"	TEGNQ2A	1.22"	4.00"	2.75"
	1.5"	TEGUQ2A	1.48"	5.00"	2.75"
	2.0"	TEHBQ2A	1.72"	7.20"	2.75"
	2.5"	TEHLQ2A	1.97"	7.20"	2.75"
	3.0"	TEJFQ2A	2.22"	9.20"	2.75"
4.0"	TEJVQ2A	2.69"	11.20"	2.75"	

SANITARY ZERO STATIC TEE ANGLE SAMPLE VALVES - TOGGLE HANDLE

SANITARY ZERO STATIC TEE ANGLE SAMPLE VALVES - TOGGLE HANDLE (Ø 0.370" INLET BORE SIZE)					
	TC RUN	PART #	"B" DIM	"C2" DIM	"D" DIM
1/2" TC OUTLET	0.5"	TEBUT2A	0.97"	3.12"	2.75"
	0.75"	TEGHT2A	1.09"	3.26"	2.75"
	1.0"	TEGNT2A	1.22"	3.25"	2.75"
	1.5"	TEGUT2A	1.48"	3.45"	2.75"
	2.0"	TEHBT2A	1.72"	3.45"	2.75"
	2.5"	TEHLT2A	1.97"	3.45"	2.75"
	3.0"	TEJFT2A	2.22"	3.45"	2.75"
	4.0"	TEJVT2A	2.69"	3.45"	2.75"

SANITARY ZERO STATIC TEE ANGLE SAMPLE VALVES - TOGGLE HANDLE CONFIGURATION

EXAMPLE: PART# **TEGCN2A*** - 3/8" HB OUTLET X 0.5" AUTOWELDED RUN INLET ZERO STATIC TEE ANGLE SAMPLE VALVE

TEGCN2A - - - - -

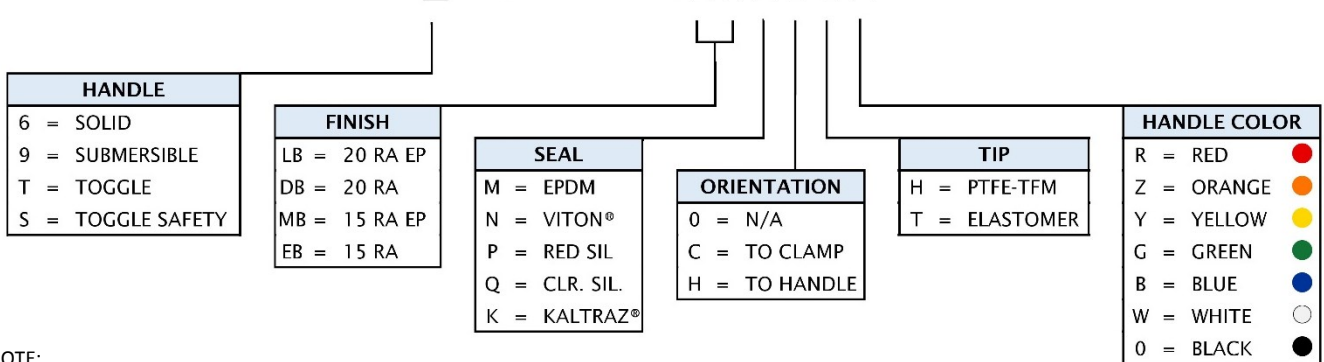

NOTE:

Custom end connections available on request. Please contact a sales representative.

VITON® is a registered trademark of DuPont Performance Elastomers.
KALTRAZ® is a registered trademark of Advant O Seal.

SANITARY ZERO STATIC TEE ANGLE SAMPLE VALVES – TOGGLE HANDLE – SPARES

SAMPLE VALVE SPARE SEALS FOR STEM CAN BE ORDERED IN TWO PACKAGING TYPES DEPENDING ON INVENTORY REQUIREMENTS TO SUIT CUSTOMER NEEDS.

SEALS FOR STEM							
SEAL MATERIAL				PART #			
				SET	KIT		
TEFLON® TIP	TEFLON® TIP	—	EPDM O-RING	TE0003M	— SET	TE0003M	— KIT
	TEFLON® TIP	—	VITON® O-RING	TE0003N	— SET	TE0003N	— KIT
	TEFLON® TIP	—	RED SIL. O-RING	TE0003P	— SET	TE0003P	— KIT
	TEFLON® TIP	—	CLR. SIL. O-RING	TE0003Q	— SET	TE0003Q	— KIT
	TEFLON® TIP	—	KALTRAZ® O-RING	TE0003K	— SET	TE0003K	— KIT
ELASTOMER TIP	EPDM TIP	—	EPDM O-RING	TE000ZM	— SET	TE000ZM	— KIT
	VITON® TIP	—	VITON® O-RING	TE000ZN	— SET	TE000ZN	— KIT
	RED SIL. TIP	—	RED SIL. O-RING	TE000ZP	— SET	TE000ZP	— KIT
	CLR SIL. TIP	—	CLR. SIL. O-RING	TE000ZQ	— SET	TE000ZQ	— KIT
	KALTRAZ® TIP	—	KALTRAZ® O-RING	TE000ZK	— SET	TE000ZK	— KIT

NOTES:

- 1 SET CONTAINS = (1) TIP, (1) O-RING, (1) DOWEL PIN
- 1 KIT CONTAINS = (5) TIPS, (5) O-RINGS, (5) DOWEL PINS

LOCK SCREWS	
PART#	
	6B000HA

NOTES:

- 1 UNIT = (3) LOCK SCREWS + (1) ALLEN WRENCH

O-RING LUBE	
PART#	
	6Z0009

NOTES:

- PLEASE REFER TO FLT O-RING LUBE DATA SHEET FOR SPECIFICATION